

ZREMOTI-L2RF
Zigbee Remote Controller

QUICK
GUIDE

This manual is for reference only. The specific parameters and functions may be different. Please refer to our website for most up to date instructions. www.sensbi.com

Technical Parameters

Wireless Standard: Zigbee, IEEE 802.15.4

Power Supply: CR2032 Battery

Operating Instructions

Before setup, please use a screwdriver to open the top cover of the switch. As shown in the figure, load a CR2032 battery into the product, and pay attention to the positive and negative directions of the battery.

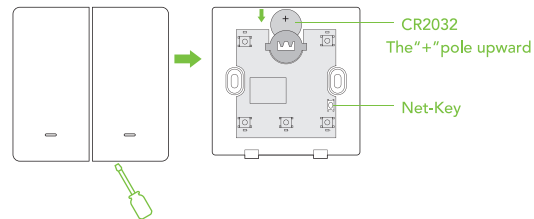

Sensbi app controls all of your smart products!

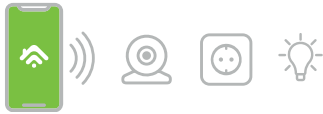

Add device to your app

Important note before getting started:

All Zigbee switches require an operating Zigbee gateway.

1. Download the Sensbi app, register if necessary, and login to your account.
2. Press and hold the Net-Key for about 5 seconds until LED blinks to enter pairing mode.
3. On the home page of the app, tap the "+" icon on the top right select add manually. Tap Electrical >> Wireless Switch (Zigbee). Then Select your Zigbee gateway and follow the prompts. Alternatively, you can also select your smart gateway interface and click "Add sub-devices" to add the device.
4. Enter the Wireless Switch interface. Configure it according to the guidelines inside.



Qualified Certification

Model:

Surveyor:

Date:

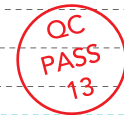

Warranty card

Name:

Contact:

Issue: